

## PAR56 REPLACEMENT PAR90/PAR120/ PAR150 POOL LIGHTS MODEL OPERATING AND SAFETY INSTRUCTIONS

Congratulations, on your purchase of one of the most advanced LED leakproof sealed ceramic technology lights, in the world today. Your Next Generation PAR90/PAR120 /PAR150 LED pool lights, will provide you with years of trouble free use and enjoyment. PAR90/PAR120/PAR150 fully sealed leak-proof technology has been proven internationally for many years. Since your new PAR90/PAR120 is consumes less power, cool running, maintenance free you need never change a globe in your pools . Please take a few minutes to read and observe the following installation and safety information. PAR90/PAR120 are AC/DC 12V - 24V . PAR150 is AC/DC 12V unless specifically stated. Please visit our AqualDEA youtube to know more Installation information.

### WARNING:

1. Our PAR90/PAR120/PAR150 are extremely bright, please **DO NOT** look directly at the light as it may damage your eyes.
2. All PAR90/PAR120 /PAR150 **MUST** switch on under the water .
3. Accessories included as below:



Stainless steel mounting kits x 3



Stainless steel screw x 9



Seal for cable dia  
7.1-7.8mm x 1  
8.5-9.5mm x 1  
10.5-11.5mm x 1



Silicone Grease

Silicone grease 5 gram x 1



PAR90 LED lights x 1 / PAR120 LED lights x1 / PAR150 LED lights x 1

### RISK OF ELECTRICAL SHOCK OR ELECTROCUTION

This underwater lights fixture must be installed by a licensed pool's technician or certified electrician or a qualified pools serviceman in accordance with all applicable local codes and ordinances. Improper installation may create an electrical hazard which could result in death or serious injury to pool users, installers or others due to electrical shock and may also cause damage to property. Always disconnect power to the pool lights at the circuit breaker before servicing the lights. Failure to do so could result in death or serious injury to serviceman, pools user or others due to electrical shock. **DO NOT** connect your new PAR lights the incorrect voltage or you may damage your lights and invalidate the warranty. All Pool lights **MUST** turn on under the water only.

### INSTALLATION INSTRUCTIONS

A: Preparatory steps which must be completed by the electrician before lights is installed see Figure 1:

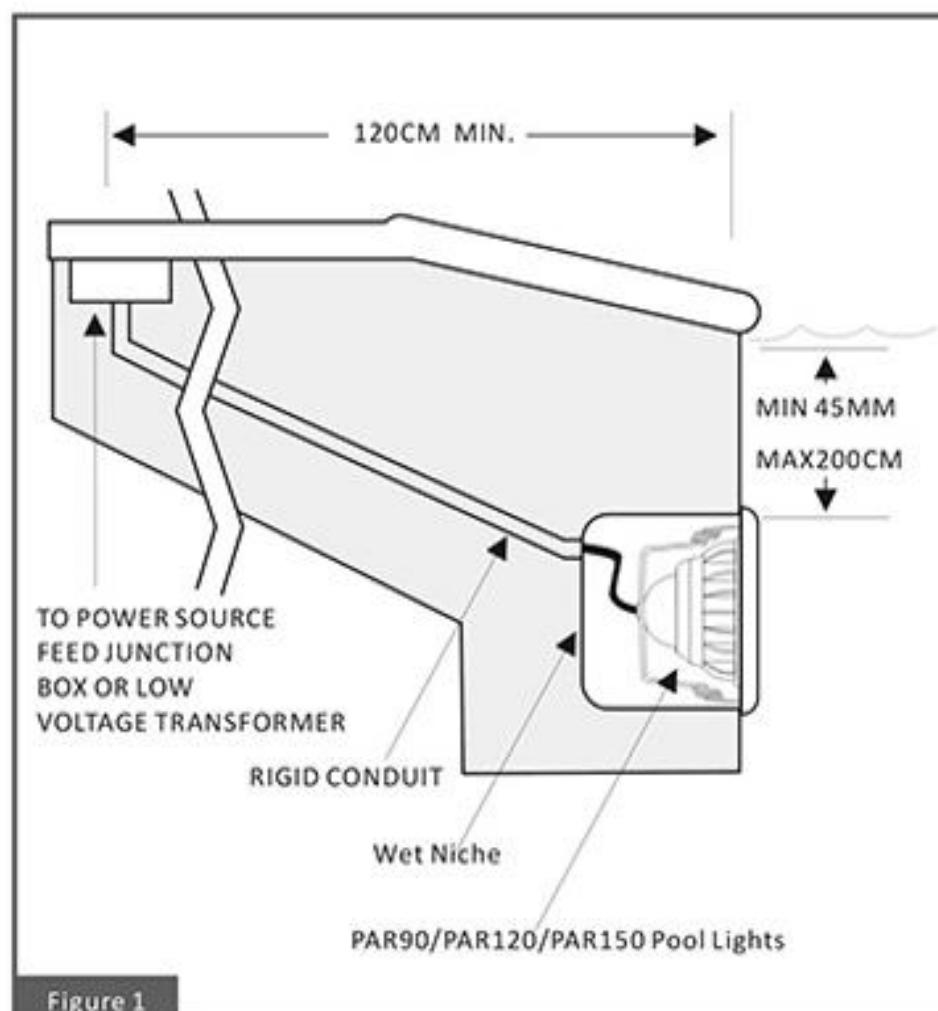

Figure 1

1. Ensure that the electrical system of the pool conforms to the requirements of all the local codes and ordinances. A licensed or certified electrician must install the electrical system to meet or exceed those requirements before the Underwater Lights is installed.
  - a) The junction box, or the low voltage transformer for 12 volt modes, **NEVER SUBMERGE THE TRANSFORMER** is located at least 120 cm from the edge of the pools, and is IP 64 splash rated see Figure 1
  - b) The lights fixture and all metal items within 240 cm of the pool must be properly electrically bonded.
  - c) The mounting bracket must be properly installed so that the edge of the face plate of the underwater light's LEDs are at least 45 cm below the surface of the water in the pools, see Figure 1.
2. Consult the local Government Building Department to be certain that the pool's electrical systems meet all applicable requirements.

## CABLE CONNECTION INSTRUCTIONS



1. Strip the pool lights cable and select appropriate gland suitable for existing cable. The gland should fit the cable firm but not too tight.



2. Insert stripped wires into the screw connectors on back of the lights and tighten with a screwdriver



3. Inject the silicone grease into the wire connector and the plastic terminal cover



4. Secure firmly with the fixing screw ensuring not to over-tighten and tighten the gland nut

## PAR LIGHTS INSTALLATION INSTRUCTIONS

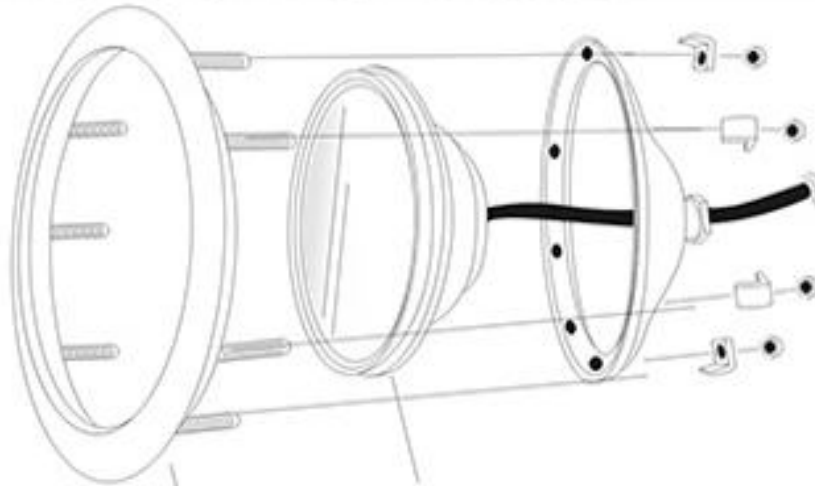

Front Cover

PAR Model Pool Lights

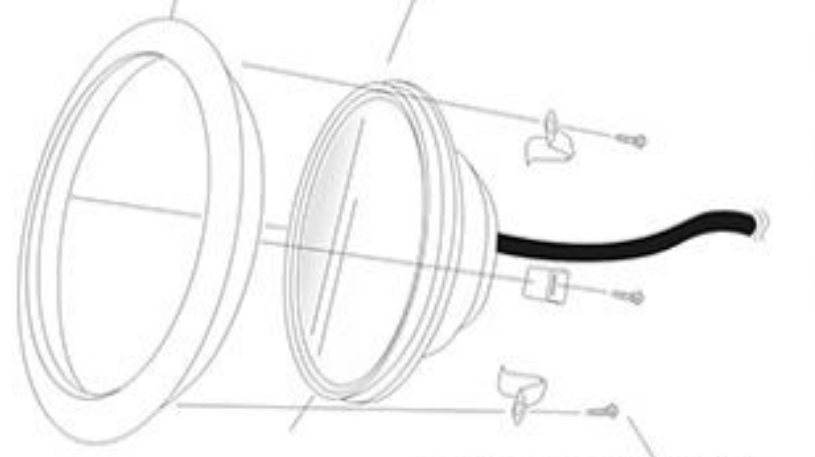

Stainless steel mounting kits



## RGB COLOUR CHANGING CONTROLLER SYSTEM

PAR RGB Lights should be installed on the same transformer and on the same switch. To achieve the synchronization when installing multiple lights on the same line. Make sure each light is installed correctly and on the same circuit. ( Figure 4) Switch the lights for more than 10 seconds, the first colour changing program will started . Turn the lights off and wait for 1-2 seconds and turn them back on. Program will be changed . \*\*If the pool lights are not at the same program. Please turn the lights off and wait 3-6second and turn the lights on . All pool lights program will back to program no 1 \*\*

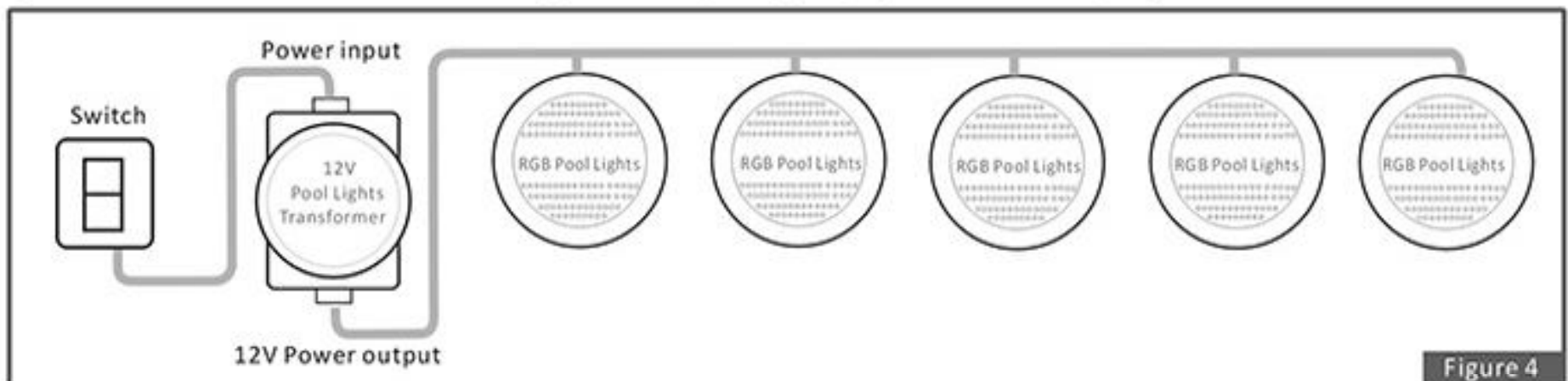

Figure 4

### RGB Programs

- |   |                                   |                                     |
|---|-----------------------------------|-------------------------------------|
| 1. Deep Blue Sea :Slow animation for Blue | 5. Ocean Blue : One colour Blue   | 8. Neutral white : One colour White |
| 2. Party :Fast animation for all colour   | 6. Glass land : Blue and Green    | 9. Pink Lady : Red/Blue             |
| 3. Sun Set :Slow animation for Red        | 7. Ocean Green : One colour Green | 10. Sunset : Red/Green/Blue         |
| 4. Sky blue : Green and Blue              |                                   | 11. Orange Road : Red/ Green        |