

Installation & RGB System Control Instructions

Warranty No: _____
Please Keep this for warranty

COMPACT SP 90 and SP150 (1.5" RETURN FITTING) POOL & SPA LIGHTS OPERATING AND SAFETY INSTRUCTIONS

Congratulations, on your purchase of one of the most advanced LED leakproof sealed ceramic technology lights since the world today. Your Next Generation SP90 / SP150 pool & spa lights, will provide you with many years of trouble free use and enjoyment. The SP Series leak-proof technology has been proven internationally for many years and consumes less power, runs cooler, requires no maintenance and you will never have to change a globe in your pools again. The SP series requires between 12V AC/DC.

Please take a few minutes to read the following installation and safety information.

WARNING:

1. SP90 / SP150 are extremely bright, please DO NOT look directly at the light as it may damage your eyes.
2. SP90 / SP150 MUST only be operated under the water.
3. Accessories included as below:



Silicone rim x 1



Heat-Shrink Tube:
Ø3mm x 2
Ø9mm x 1
Ø15mm x 1



SP 90 Spa underwater LED lights x 1 / SP 150 Spa underwater LED lights x1

Your SP90 / SP150 lights fixtures must be installed by a qualified pool's person / persons in accordance with all applicable local codes and standards. Improper installation may create an electrical hazard which could result in serious injury to pool users, installers or others due to electrical shock and may cause damage to property. Always disconnect to the pool lights before servicing. DO NOT connect your new SP90 / SP150 to the incorrect voltage or you may damage your lights and void warranty. All pool lights **MUST** be turned on under the water only

INSTALLATION INSTRUCTIONS

A: Preparatory steps which must be completed by the electrician or pool builder before light is installed see Figure 1:

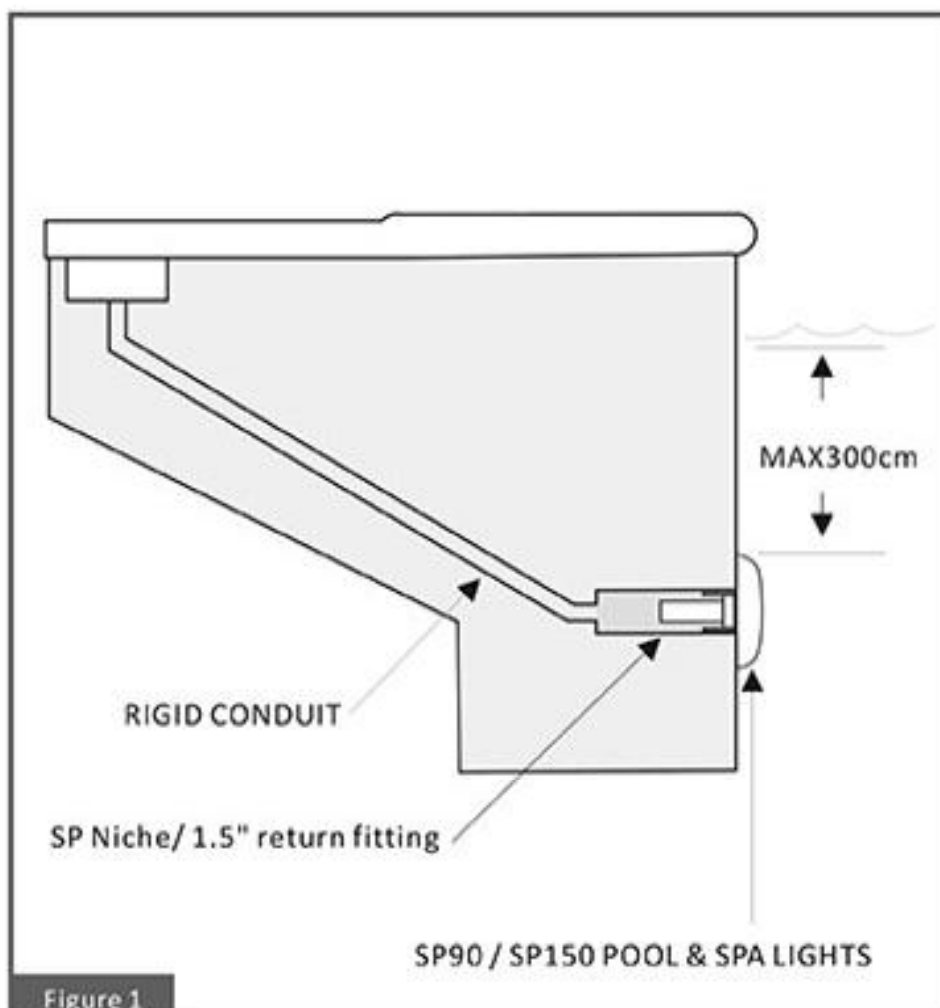

Figure 1

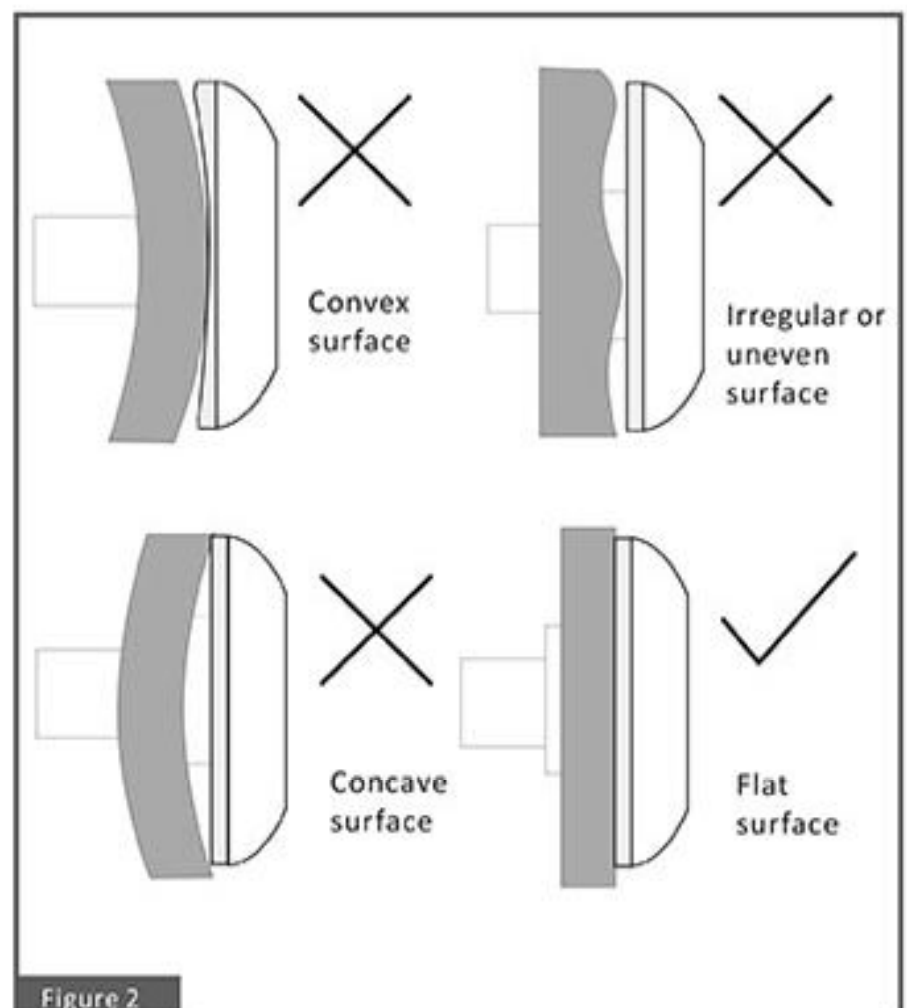
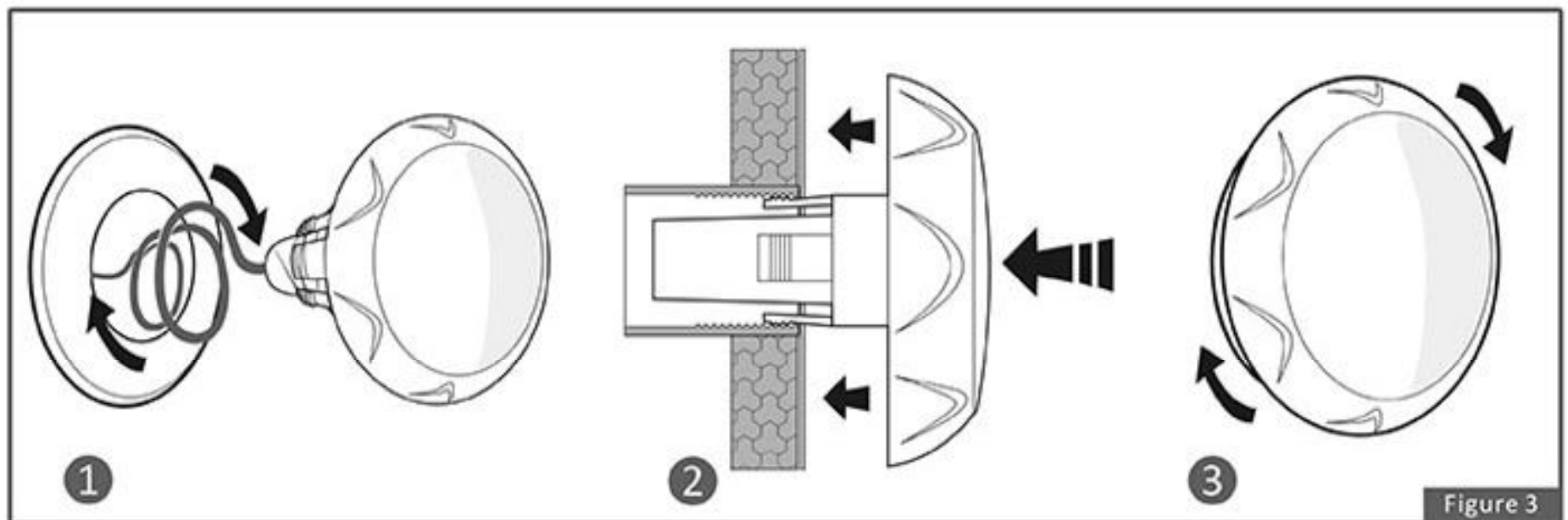

Figure 2

A: SP model Pool & Spa lights must be properly installed so that the edge of the face plate of the underwater light's LEDs are at least 45mm below the surface of the water in the pools.

B: Perform the following steps after the electrical system requirements are met.

1. Locate position on the vertical wall where lights are to be installed. The edge of the face plate must be 30~60 cm below normal water level, see Figure 1
2. Coil the extra cable (maximum of 2M) into the SP series niche. Small coils work best. Push to the back of the niche and leaving room for the SP series lights body (Figure 3-1)
3. Align the lights into the niche and push gently but firm into place (Figure 3-2)
4. Once seated into position, lock by turning the lights clockwise , unlock turn anti-clockwise (Figure 3-3)
5. This extra cable allows you to bring the lights out of the pools for maintenance.
6. Connect cable electrical wires to the 12V AC/DC transformer .



RGB COLOUR CHANGING CONTROLLER SYSTEM

SP90 / SP150 RGB lights should be installed on a multi tapped transformer or multiple transformers on the same switch. To achieve synchronization when installing multiple lights, Make sure each lights is installed correctly and on the same circuit. (Fig 4). Switch the light s on for more than 10 seconds, the first colour changing pro gram will start . Turn the lights switch off and wait for 1- 2 second s and turn back for program to change . **If the pool lights are not on the same program, Please turn the lights off , wait 3-6 second and turn the lights back on to return to program 1.

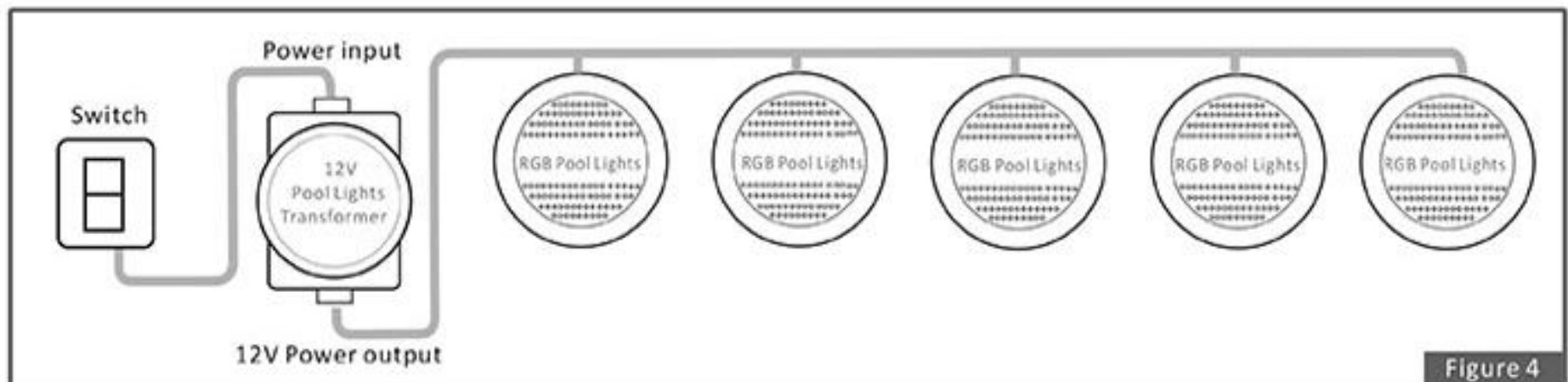

SP90 / SP150 RGB Programs

- | | | |
|---|-----------------------------------|-------------------------------------|
| 1. Deep Blue Sea :Slow animation for Blue | 5. Ocean Blue : One colour Blue | 8. Neutral white : One colour White |
| 2. Party :Fast animation for all colour | 6. Glass land : Blue and Green | 9. Pink Lady : Red/Blue |
| 3. Sun Set :Slow animation for Red | 7. Ocean Green : One colour Green | 10. Sunset : Red/Green/Blue |
| 4. Sky blue : Green and Blue | | 11. Orange Road : Red/ Green |