

COMPACT SPT 90 and SPT150 POOL & SPA LIGHTS OPERATING AND SAFETY INSTRUCTIONS

Congratulations, on your purchase of one of the most advanced LED leakproof sealed ceramic technology lights since the world today. Your Next Generation SPT90 / SPT150 pool & spa lights, will provide you with many years of trouble free use and enjoyment. The SP Series fully sealed leak-proof technology has been proven internationally for many years and consumes less power, runs cooler, requires no maintenance and you will never have to change a globe in your pools again. The SP series requires 12V AC/DC.

Please take a few minutes to read the following installation and safety information.

WARNING:

1. SPT90 / SPT150 are extremely bright, please DO NOT look directly at the light as it may damage your eyes.
2. SPT90 / SPT150 MUST only be operated under the water.
3. Accessories included as below:

	Heat-Shrink Tube:
	Ø 3mm x 2
	Ø 9mm x 1
	Ø 15mm x 1



SPT 90 Underwater LED pool lights x 1 / SPT 150 underwater LED pool lights x1

RISK OF ELECTRICAL SHOCK OR ELECTROCUTION

The SPT series lights should only be installed by a suitably qualified person. The SPT series is a sealed unit and does not contain any serviceable parts.

DO NOT connect your new SPT90 / SPT150 to the incorrect voltage or you may damage your lights and void warranty.

All Pool lights MUST operate under the water only.

Any attempt to disassemble, alter, change or tamper with the lights will automatically void warranty.

INSTALLATION INSTRUCTIONS

A: Preparatory steps which must be completed by the electrician or pool builder before light is installed see Figure 1:

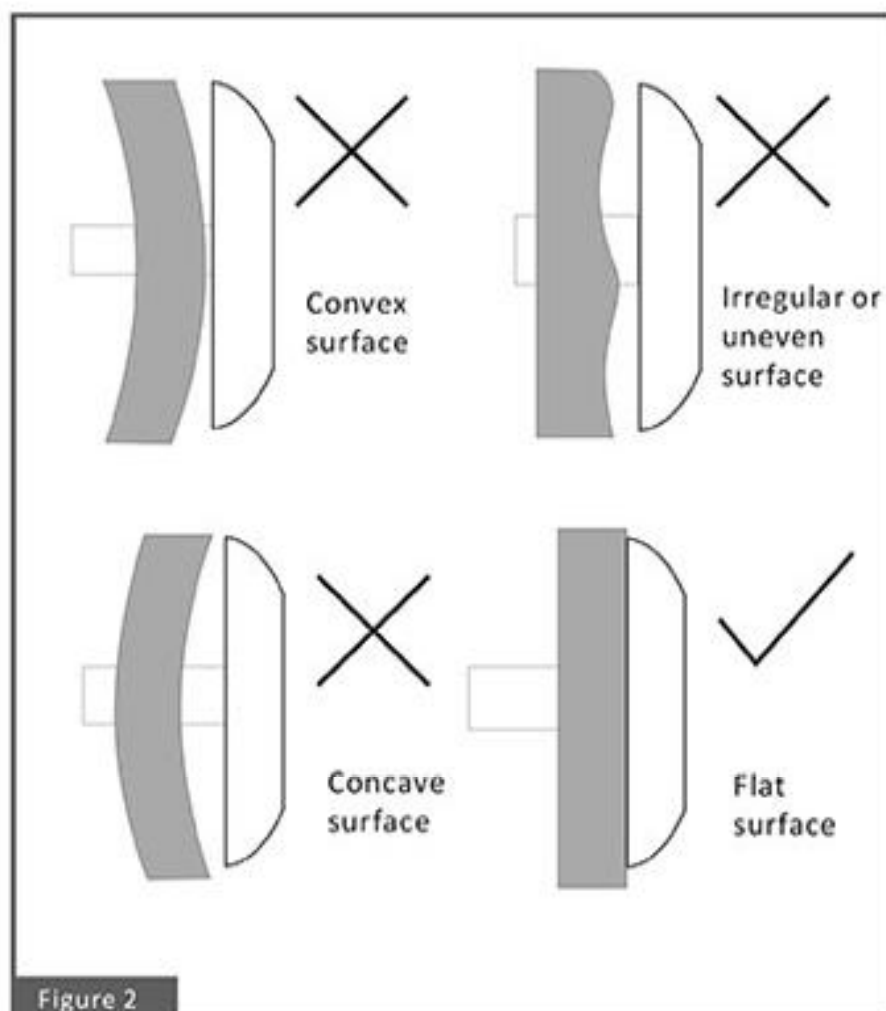
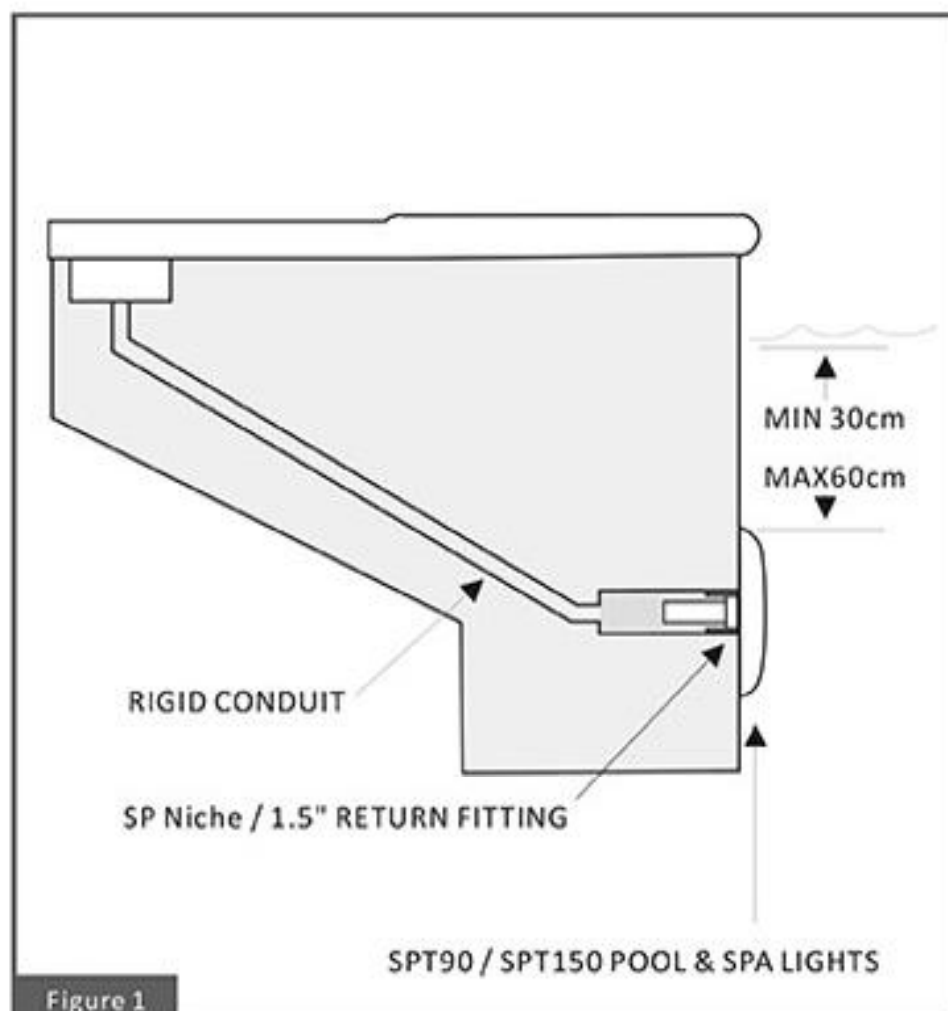

- A. Ensure that the electrical system of the pool conforms to the requirements of all the local codes and standards. A licensed certified electrician must install the electrical system to meet or exceed those requirements before the Underwater Lights is installed.

SPT model Pool & Spa lights must be properly installed so that the edge of the face plate of the underwater light's LEDs are at least 30 cm below the surface of the water in the pools, (Fig 1)

B: Perform the following steps after the electrical system requirements are met.

1. Locate position on the vertical wall where lights are to be installed. The edge of the face plate must be 30~60 cm below normal water level, see Figure 1
2. Coil the extra cable (maximum of 2M) into the SPT series niche. Small coils work best. Push to the back of the niche and leaving room for the SP series lights body (Figure 3-1)
3. Align the lights into the niche and push gently but firm into place (Figure 3-2)
4. Once seated into position, lock by turning the lights clockwise , unlock turn anti-clockwise (Figure 3-3)
5. This extra cord allows you to bring the lights out of the pools for maintenance.
6. Connect cord electrical wires at 12V AC/DC transformer , through conduit.
7. Connect all wires to the corresponding circuit wires in the junction box and feed to cable housing.
8. Limit the running time of the lights to a maximum of 8hr a day to preserve the life of your SP series LED Compact Lights

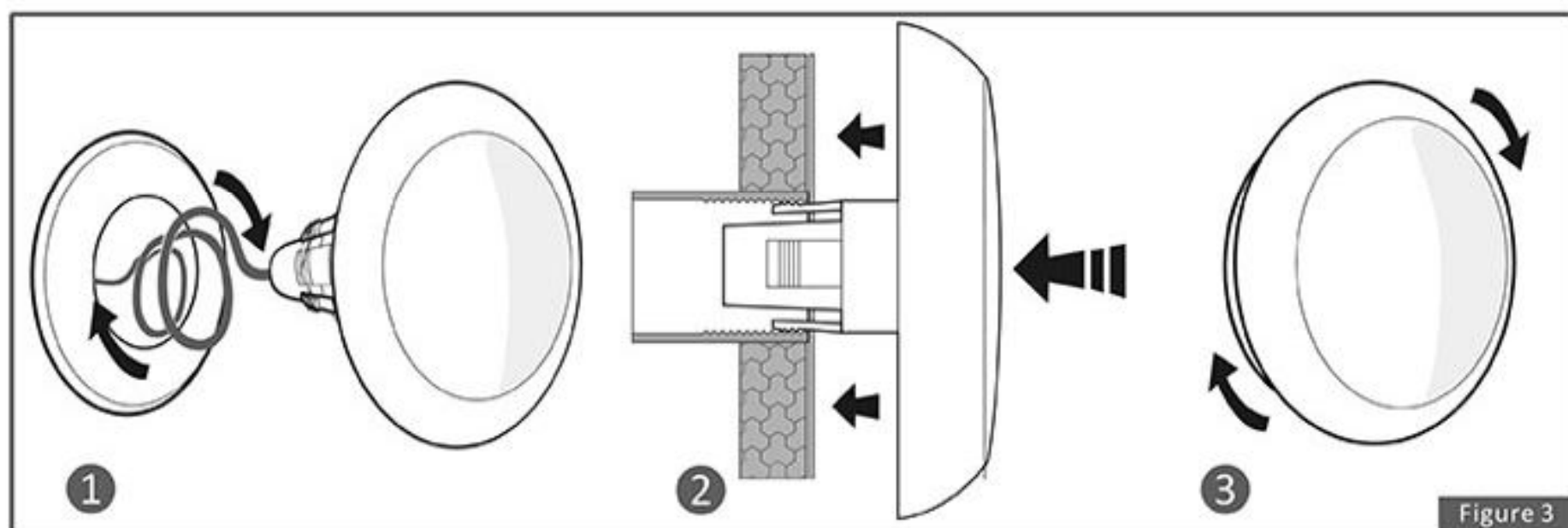

Figure 3

RGB COLOUR CHANGING CONTROLLER SYSTEM

SPT90 / SPT150 RGB Lights should be installed on a multi tapped transformer or multiple transformers on the same switch. To achieve synchronization when installing multiple lights, Make sure each lights is installed correctly and on the same circuit. (Fig 4). Switch the lights on for more than 10 seconds, the first colour changing pro gram will start . Turn the lights switch off and wait for 1- 2 second s and turn back for program to change . **If t he pool lights are not on the sam e program, Please turn the lights off , wait 3-6 second and turn the lights back on to return to program 1.

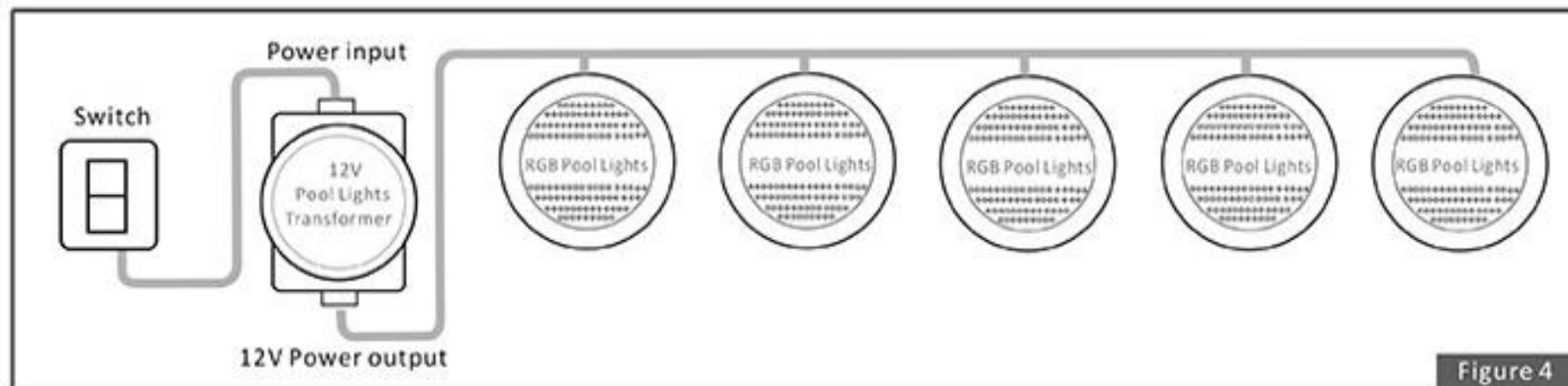

Figure 4

SPT90 / SPT150 RGB Programs

- | | | |
|---|-----------------------------------|-------------------------------------|
| 1. Deep Blue Sea :Slow animation for Blue | 5. Ocean Blue : One colour Blue | 8. Neutral white : One colour White |
| 2. Party :Fast animation for all colour | 6. Glass land : Blue and Green | 9. Pink Lady : Red/Blue |
| 3. Sun Set :Slow animation for Red | 7. Ocean Green : One colour Green | 10. Sunset : Red/Green/Blue |
| 4. Sky blue : Green and Blue | | 11. Orange Road : Red/ Green |